



GLADWIN COUNTY DRAIN COMMISSIONER

Terry L. Walters
555 West Cedar Avenue
Gladwin, Michigan 48624

PARY DRAIN

**NOTICE OF DAY OF REVIEW OF DRAINAGE DISTRICT BOUNDARIES
AND REVIEW OF APPORTIONMENTS**

DATE: Thursday, August 4, 2022
TIME: 9:00 a.m. to 5:00 p.m.
LOCATION: Gladwin County Courthouse
Board of Commissioner's Room
401 West Cedar Avenue
Gladwin, Michigan 48624
QUESTIONS: (989) 312-3382

The Gladwin County Drain Commissioner will hold a Day of Review of Drainage District Boundaries and Apportionments on the above date, time, and location. The Day of Review is an opportunity to review the Pary Drain Drainage District boundaries and the tentative apportionments of benefit for each parcel and municipality within the Drainage District. A map of the proposed Drainage District boundary revisions can be found enclosed with this notice and on the Drain Commissioner's website at: <https://gladwincounty-mi.gov/departments/drain-commission>.

The Drain Commissioner, engineers, and/or other staff members will be available to assist individuals throughout the day and make revisions where necessary. There is no need to schedule an appointment for a specific time on the Day of Review. The computation of costs for the Drain will also be available at the Day of Review. Drain assessments are collected in the same manner as property taxes and will appear on your winter tax bill. If drain assessments are being collected for more than one (1) year, you may pay the assessment in full with any interest to date at any time and avoid further interest charges.

Persons with disabilities needing accommodations for effective participation in the Day of Review should contact the Drain Commissioner's Office at the number noted above (voice) or through the Michigan Relay Center at 7-1-1 (TDD) at least 24 hours in advance of the Day of Review to request mobility, visual, hearing, or other assistance.

Comments on the apportionment of benefits may be submitted to the Drain Commissioner in writing before the date of the day of review to the Gladwin County Drain Commissioner at 555 West Cedar Avenue, Gladwin, Michigan 48624 or to drains@gladwincounty-mi.gov, or comments may be submitted in writing or verbally at the day of review. Comments submitted in advance must be received by the Drain Commissioner prior to the day of review to ensure consideration.

The following is a list of any county, township, city, or village to be assessed: Gladwin County and Billings Township.

You may appeal the Drain Commissioner's decision to revise the district boundary to the Gladwin County Circuit Court within ten (10) days, and you may also appeal the determination of apportionments to the Gladwin County Probate Court within ten (10) days.

Terry Walters
Gladwin County Drain Commissioner

PARY DRAIN DRAINAGE DISTRICT
GLADWIN COUNTY DRAIN COMMISSIONER
TERRY L. WALTERS

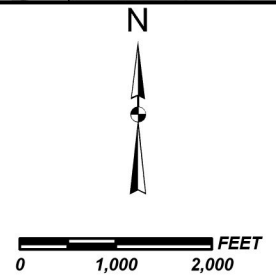
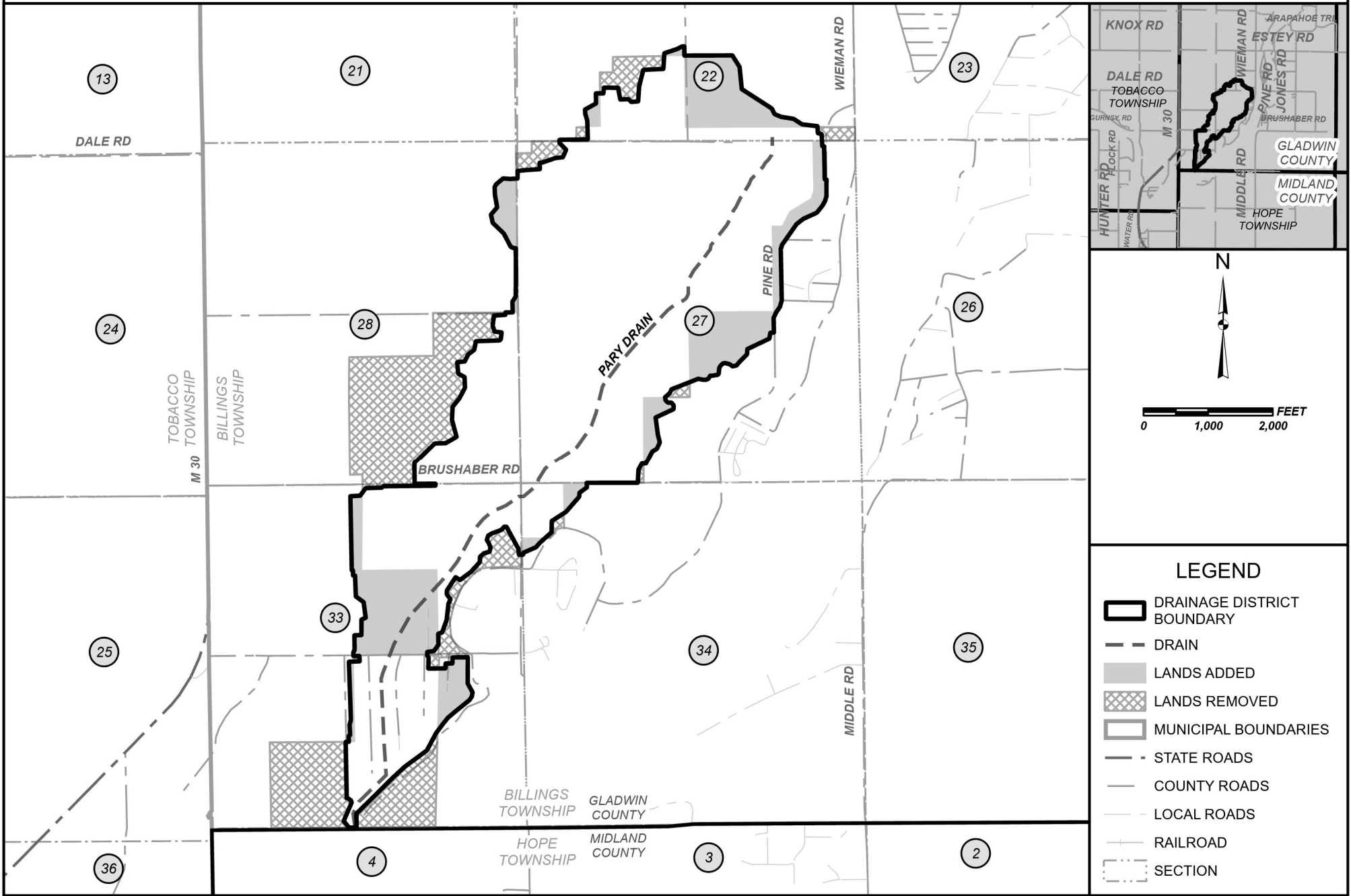

- LEGEND**
- DRAINAGE DISTRICT BOUNDARY
 - DRAIN
 - LANDS ADDED
 - LANDS REMOVED
 - MUNICIPAL BOUNDARIES
 - STATE ROADS
 - COUNTY ROADS
 - LOCAL ROADS
 - RAILROAD
 - SECTION